



# Installation Instruction - Electrical

Applicable for R306

## Contents

<b>1</b>	<b>General .....</b>	<b>2</b>
<b>2</b>	<b>Go/No Go Testing.....</b>	<b>2</b>
2.1	Test Set-Up Go/No Go test .....	2
2.2	Test Set .....	3
2.3	RF Connections Antenna Coupler.....	3
2.4	RF Connections Test Fixture (optional).....	3
<b>3</b>	<b>Software Loading .....</b>	<b>4</b>
3.1	Set up .....	4
3.2	Computer.....	4
3.3	USB Activation Dongle .....	4
3.4	Sony Ericsson programming interface – DCU-65 .....	4
<b>4</b>	<b>Software .....</b>	<b>5</b>
4.1	EMMA.....	5
4.2	Labelmake II software (optional) .....	5
4.3	SERP Go/No Go Test Script .....	5
4.4	SERP Calibration (only authorized centers) .....	5
4.5	Willtek 420x Go/No-Go Test Script .....	6
<b>5</b>	<b>Lead-Free Electrical Repair .....</b>	<b>6</b>
<b>6</b>	<b>Revision History .....</b>	<b>8</b>

# 1 General

The Electrical Installation Instructions describes the procedures for installing all of the hardware and software needed to perform testing, software loading and repair activities at an Electrical level for the Sony Ericsson products specified.

## 2 Go/No Go Testing

There are two options for performing a Go No/Go test. One is to use an RF Fixture and the other is to use an antenna coupler together with a shielding box.

### 2.1 Test Set-Up Go/No Go test

All test hardware necessary for this test set up is documented in the Mechanical or Electrical Equipment Lists.

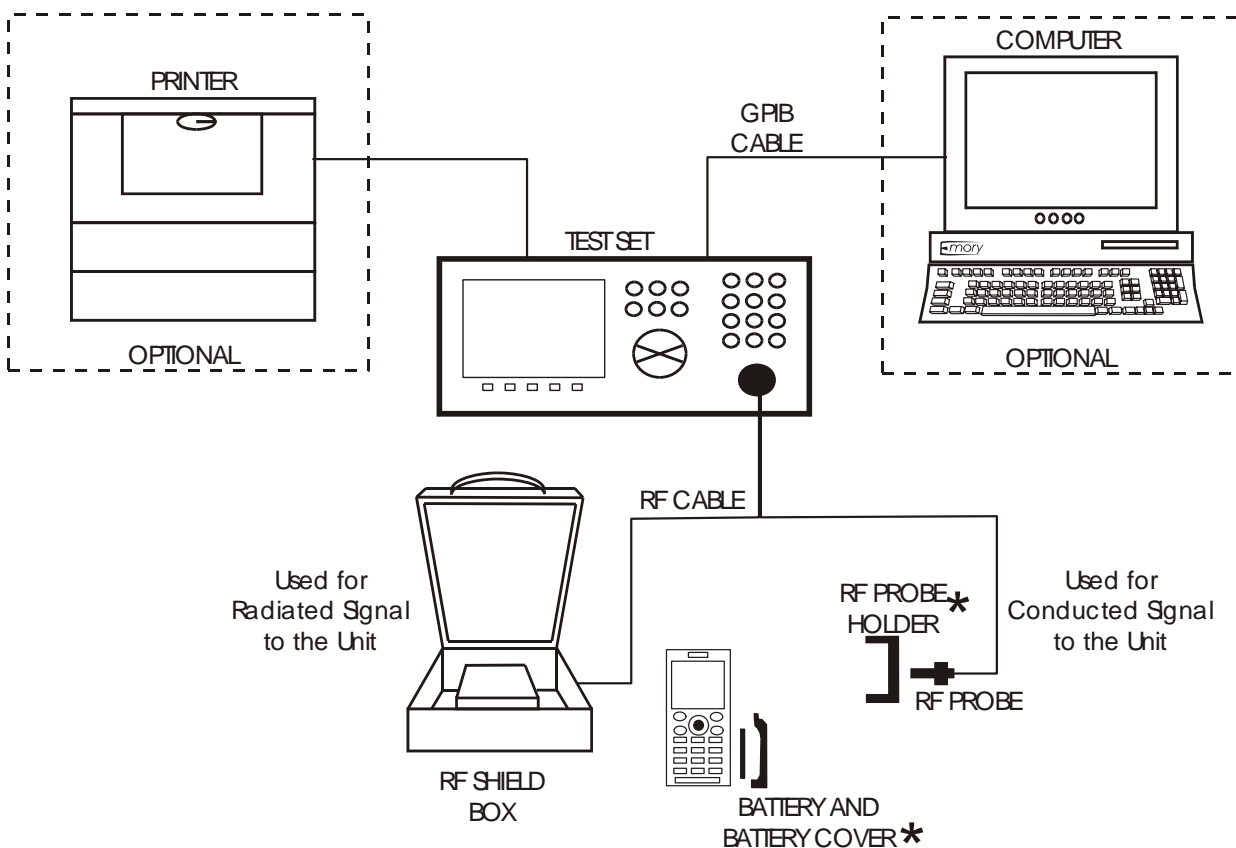

\* The RF Probe Holder and the Battery Cover may not be used for every product. See the Installation Instructions and Test Instructions for details.

## **2.2 Test Set**

A 900/GSM, 1800/GSM, 1900/GSM and WCDMA Test Set approved according to the Tool Catalogue must be used for the product

It should be installed according to the Instrument Manufacturer Instructions.

## **2.3 RF Connections Antenna Coupler**

Connect the RF Cable between the RF-port of the Test set and the RF Shield box. The Antenna Coupler should be installed into the RF Shield Box according to manufacturer instructions.

## **2.4 RF Connections Test Fixture (optional)**

Connect the RF-cable between the RF-port of the Test set and the RF Probe. Assemble the RF Probe to the RF-holder according to the information in the Test Instruction Electrical.



## 3 Software Loading

### 3.1 Set up

General Test set up to perform SW loading. All necessary hardware for this test set up is documented in the Mechanical or Electrical Equipment list.

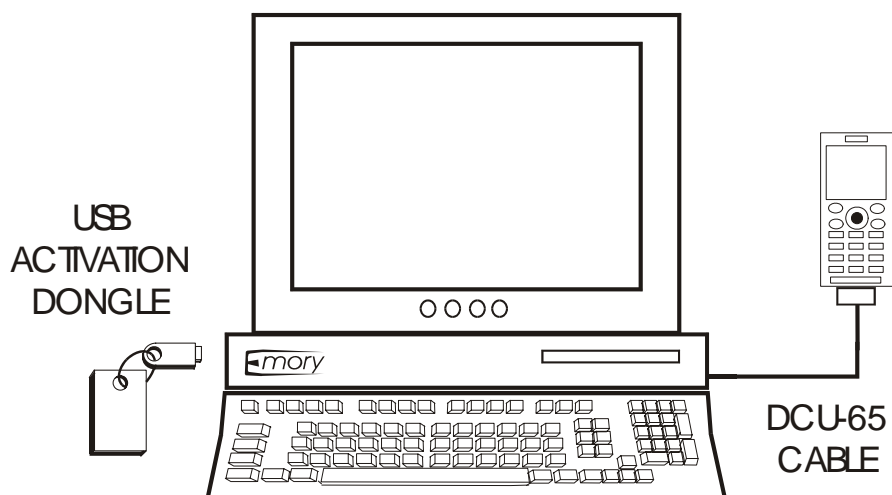

### 3.2 Computer

IBM compatible computer is required. The computer should include at least three USB-ports, if the computer has a Card Reader built in only two USB-ports are required. Refer to Equipment List for minimum requirements.

### 3.3 USB Activation Dongle

A USB Activation Dongle is required for activation in EMMA. Refer to the EMMA Homepage available from CSPN, for installation instructions.

### 3.4 Sony Ericsson programming interface – DCU-65

The cable is the interface between the computer and the phone. DCU-65 cable should be connected to an USB-port on the computer.

## 4 Software

### 4.1 EMMA

EMMA contains all software required to service the product. Installation and user manuals are available in the EMMA start page.

<http://ma3.extranet.sonyericsson.com/ma3/>

### 4.2 Labelmake II software (optional)

Label Make II is an application installed through Java Web Start.

Access the Labelmake software from [CSPN](#) Web page.

You will find Label Make II in the dropdown menu on the CSPN web page.

<http://cspn.extranet.sonyericsson.com>

Press "START Label Make II" button and you will be directed to the LABELMAKE II client page.

Product labels are downloaded on-line from a remote server database.

### 4.3 SERP Go/No Go Test Script

SERP stands for "**S**ony **E**ricsson **R**epair **P**latform". It is an application used for testing, calibrating and repairing Sony Ericsson mobile phones.

1. Download the latest revision of the SERP application from CSPN (**Repair Instructions/Standard/SERP Install Package**).
2. Unzip the file and open the file "Release Notes and Installation Guide" for installation instructions.
3. After SERP is installed a file titled "SERPINFO.htm" will be placed on the Windows Desktop. This file contains numerous documents including:
  - SERP Users Manual – This document contains detailed operating and fault reporting instructions.
  - R&S Grid plate for SERP – This document contains an overview and ordering information for the Rhode & Schwarz Grid Plate used with the Rhode & Schwarz coupler. Also there is a list of supported SEMC handsets and mounting positions.
  - SERP Release Notes and Installation Guide – This document contains system requirements, release notes and an Installation Guide

### 4.4 SERP Calibration (only authorized centers)

Download the latest revision of SERP application from [CSPN](#). This application is located under [Repair Instructions/Standard/SERP Install package](#)

<http://cspn.extranet.sonyericsson.com>

1. Unzip the file and open the Installation instructions.
2. Follow the Install instructions to install SERP.

## 4.5 Willtek 420x Go/No-Go Test Script

An approved Sony Ericsson Test Script must be installed in the Test Instrument. The Willtek 420x script can be downloaded from CSPN. The Test Script is located on CSPN under **Repair Instructions / Standard**.

The FEA number for the 420x test script is 1211-9597 x when using the R&S Coupler or the RF Fixture.

**NOTE!** The “x” in the FEA number refers to the revision of the Test Script. Ensure the latest revision script posted to CSPN is installed.

Install the Test Script according to the Instrument Manufacturer’s Instructions.

## 5 Lead-Free Electrical Repair

This product is manufactured with lead-free solder and lead-free components. During electrical repair, it is critical to make sure that no lead is introduced into the product. For this reason, certain repair materials and equipment must be designated as lead-free and labelled accordingly. A lead-free work area must be setup that is completely separated from work areas that are used to make leaded repairs. The lead-free work area must also be clearly labelled as shown in the figure below. Certain items must be designated for lead-free work only. Some of the items that need to be clearly labelled in this way are listed in the table below. Note that any item that contacts the solder must be labelled and used for lead-free work only.

Soldering Tips	Wicking Tape	Tip Cleaner (steel wool)
Solder	Tip Tinner	Soldering Iron





Because of cost and space limitations, some repair centres may not be able to assign a full bench to lead-free repairs. In this case, both lead-free and leaded repair setups can share the same bench, but they must be clearly marked with signs and separated by a physical divider. In the figure below, the large hot air device functions as the divider.

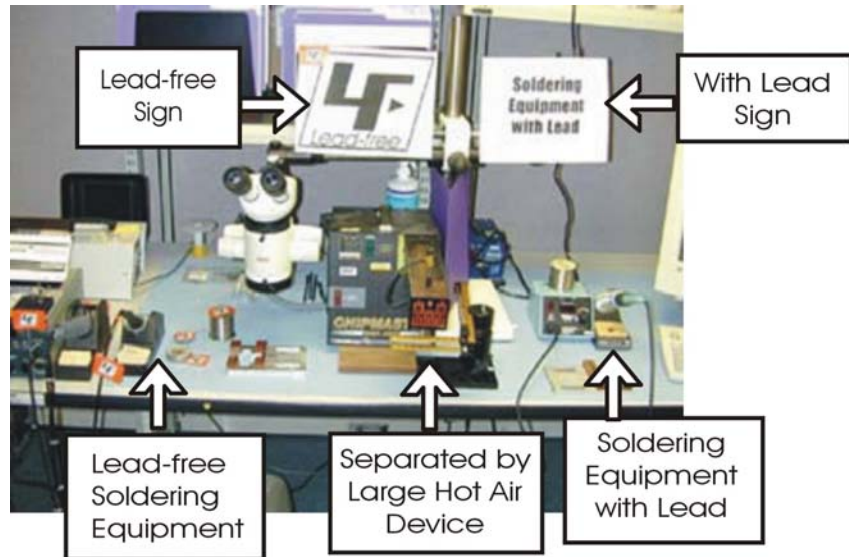

## 6 Revision History

Rev.	Date	Changes / Comments
1	2008-08-15	1 <sup>st</sup> version